

**QT-Brightek Chip LED Series**

**SMD 0603 Green LED**

**Part No.: QBLP601-AG1A-2897**

**A: 10mA  
2897: High Bright**



---

**Table of Contents:**

Introduction ..... 3  
Electrical / Optical Characteristic (Ta=25 °C) ..... 4  
Absolute Maximum Rating ..... 4  
Solder Profile & Footprint ..... 6  
Packing ..... 7  
Ordering Information ..... 8  
Revision History ..... 8  
Disclaimer ..... 8

## Introduction

### Feature:

- Water clear lens
- Color: Green
- Package in tape and reel
- 0603 LED package
- Viewing angle: 140 deg typ.
- Height profile: 0.6mm

### Application:

- Status indication
- Back lighting application

### Certification & Compliance:

- ISO9001
- RoHS Compliant



### Dimension:

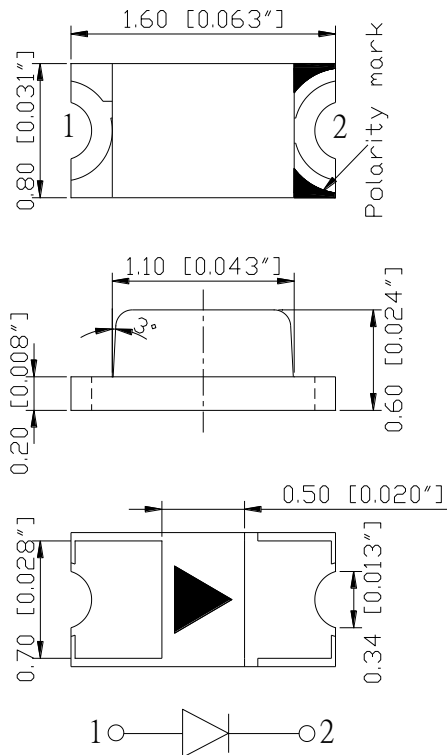

Units: mm / tolerance = +/-0.1mm

## Electrical / Optical Characteristic (Ta=25 °C)

Product	Color	I <sub>F</sub> (mA)	V <sub>F</sub> (V)		λ <sub>D</sub> (nm)			λ <sub>P</sub> (nm)	I <sub>v</sub> (mcd)	
			Typ.	Max.	Min.	Typ.	Max.	Typ.	Min.	Typ.
QBLP601-AG1A-2897	Green	10	2.0	2.3	566	571	575	574	25	35

## Absolute Maximum Rating

Chip Material	P <sub>d</sub> (mW)	I <sub>F</sub> (mA)	I <sub>FP</sub> (mA)*	V <sub>R</sub> (V)	T <sub>OP</sub> (°C)	T <sub>ST</sub> (°C)	T <sub>SOL</sub> (°C)**
AllnGaP	69	30	100	5	-40 ~ +80	-40 ~ +85	260

\*Duty 1/10 @ 1KHz

\*\*IR Reflow for no more than 10 sec @ 260 °C

## Forward Voltage V<sub>F</sub> @ I<sub>F</sub>=10mA

Bin	Min.	Max.	Unit
A	1.7	2.0	V
B	2.0	2.3	

## Luminous Intensity I<sub>v</sub> @ I<sub>F</sub>=10mA

Bin	Min.	Max.	Unit
C	25	31.3	mcd
D	31.3	40	
E	40	50	
F	50	63	

## Dominant Wavelength λ<sub>D</sub> @ I<sub>F</sub>=10mA

Bin	Min.	Max.	Unit
H	566	569	nm
I	569	572	
J	572	575	

## Characteristic Curves

Forward Current vs. Forward Voltage

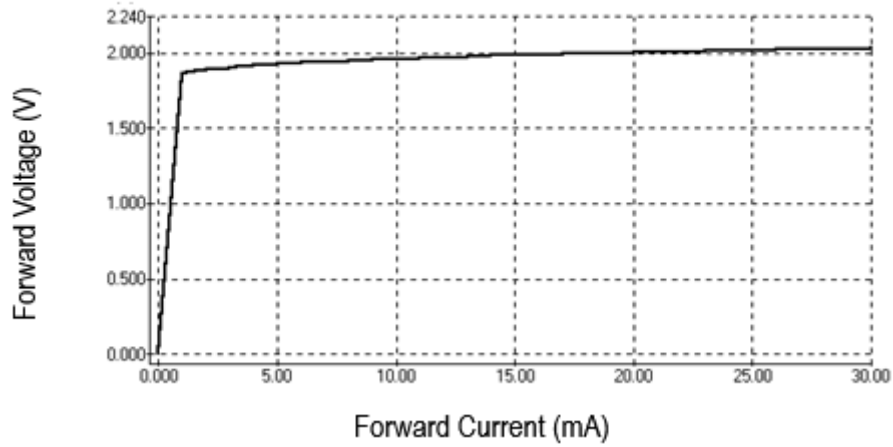

Relative Intensity vs. Wavelength

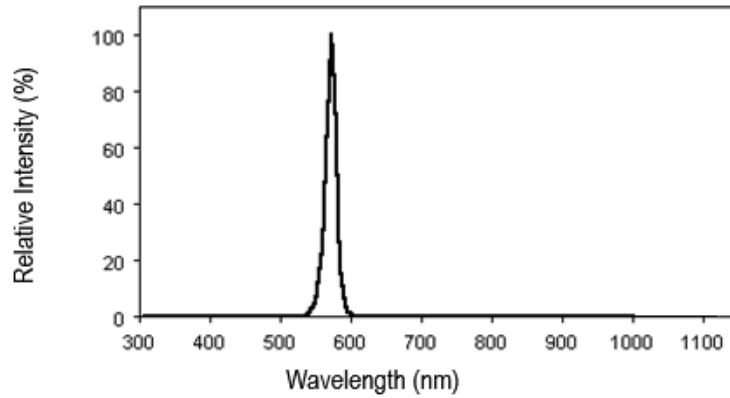

Directive Characteristics

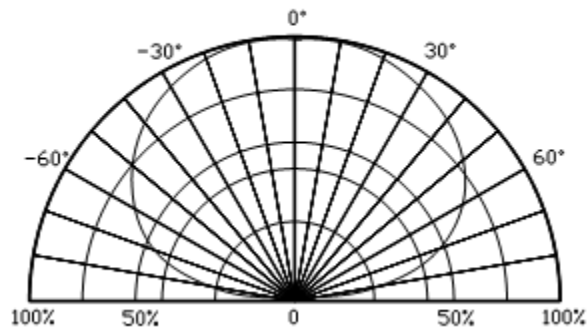

## Solder Profile & Footprint

-The recommended reflow soldering profile is as follows (temperatures indicated are as measured on the surface of the LED resin):

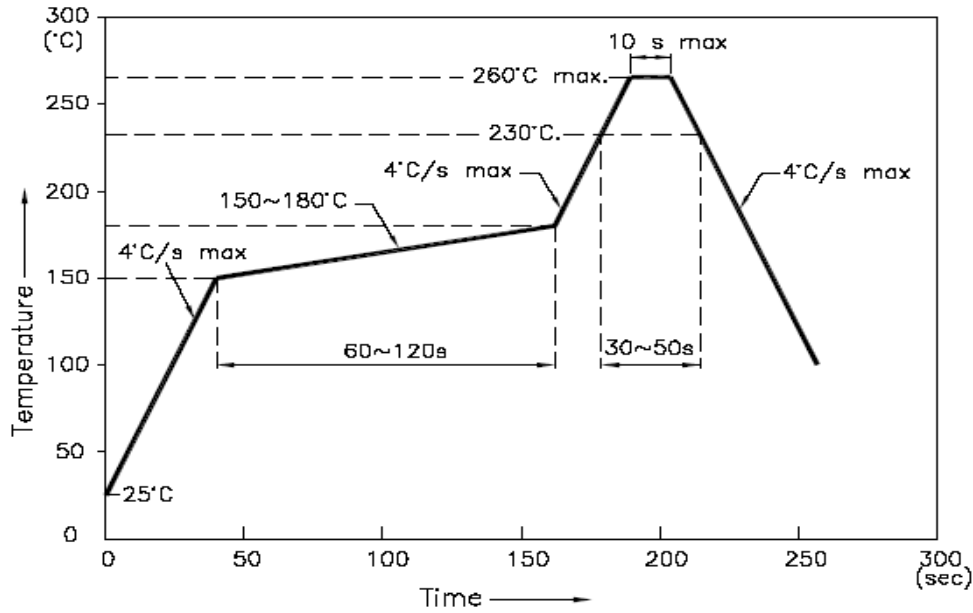

### Recommended Pad Layout

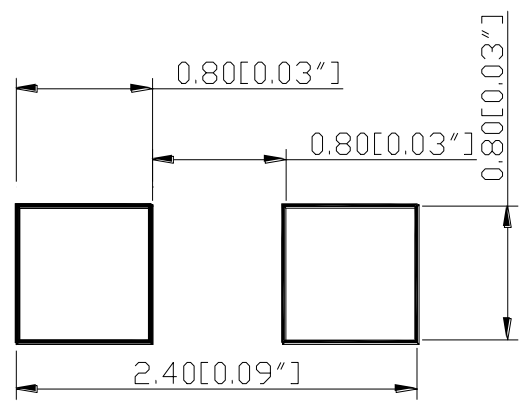

Units: mm

## Packing

### Reel Dimension:

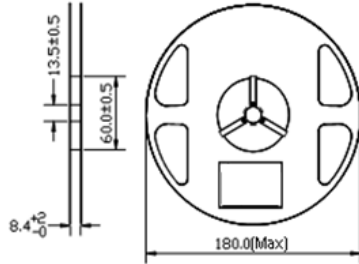

Unit: mm

### Tape Dimension:

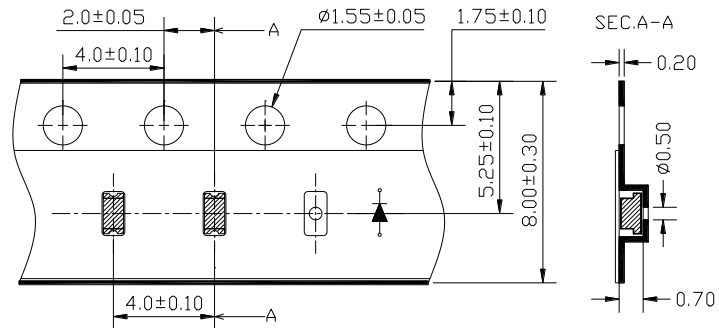

Unit: mm

### Arrangement of Tape:

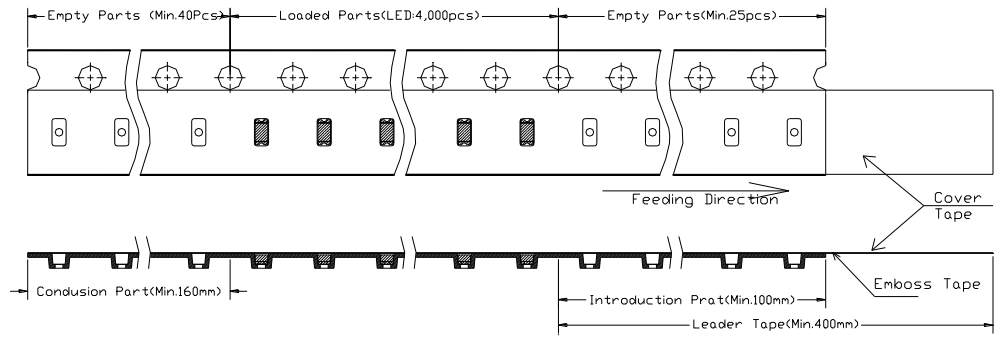

### Packaging Specifications:

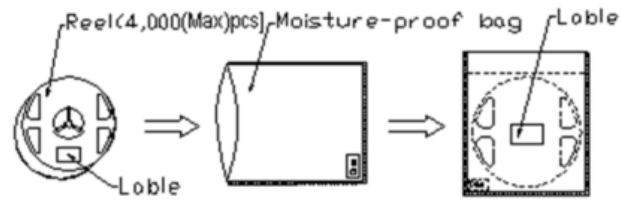



## Ordering Information

Orderable Part #	Spec Range	Quantity per reel
QBLP601-AG1A-2897	Iv=35mcd typ. @ I <sub>F</sub> =10mA / Color=566 to 575nm	4,000 units

## Revision History

Description:	Revision #	Revision Date
New Release of QBLP601-AG1A-2897	V1.0	10/28/2025

## Disclaimer

QT-BRIGHTTEK reserves the right to make changes without further notice to any products herein to improve reliability, function or design. QT-BRIGHTTEK does not assume any liability arising out of the application or use of any product or circuit described herein; neither does it convey any license under its patent rights, nor the rights of others.

## Life Support Policy

QT-BRIGHTTEK's products are not authorized for use as critical components in life support devices or systems without the express written approval of QT-BRIGHTTEK. As used herein:

1. Life support devices or systems are devices or systems which, (a) are intended for surgical implant into the body, or (b) support or sustain life, and (c) whose failure to perform when properly used in accordance with instructions for use provided in the labeling, can be reasonably expected to result in a significant injury of the user.
2. A critical component in any component of a life support device or system whose failure to perform can be reasonably expected to cause the failure of the life support device or system, or to affect its safety or effectiveness.

Product: QBLP601-AG1A-2897	Date: October 28, 2025	Page 8 of 8
	Version# 1.0	