

QT-Brightek Chip LED Series

SMD 0603 LED

Part No.: QBLP601-RA-2897

**A: 10mA
2897: High Brightness Version**



Table of Contents:

Introduction 3
Electrical / Optical Characteristic (Ta=25 °C) 4
Absolute Maximum Rating 4
Solder Profile & Footprint 6
Packing 7
Labeling 8
Ordering Information 8
Revision History 9
Disclaimer 9

Introduction

Feature:

- Water clear lens
- Package in tape and reel
- Ultra bright 0603 LED package
- AllnGaP technology
- Viewing angle: 140 deg typ.
- Height profile: 0.6mm

Application:

- Status indication
- Back lighting application

Certification & Compliance:

- ISO9001
- RoHS Compliant



Dimension:

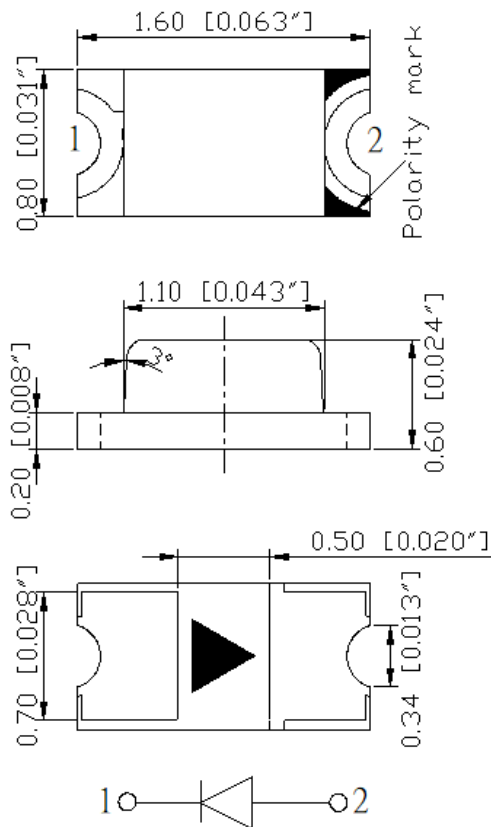

Units: mm / tolerance = +/-0.1mm

Electrical / Optical Characteristic (Ta=25 °C)

Product	Color	I _F (mA)	V _F (V)		λ _D (nm)			λ _P (nm)	I _V (mcd)	
			Typ.	Max.	Min.	Typ.	Max.	Typ.	Min.	Typ.
QBLP601-RA-2897	Red	10	2.0	2.3	615	625	630	630	150	250

Absolute Maximum Rating

Chip Material	P _d (mW)	I _F (mA)	I _{FP} (mA)*	V _R (V)	T _{OP} (°C)	T _{ST} (°C)	T _{SO L} (°C)**
AllnGaP	69	30	120	5	-40 ~ +80	-40 ~ +85	260

*Duty 1/10 @ 1KHz

**IR Reflow for no more than 10 sec @ 260 °C

Forward Voltage V_F @ I_F=10mA

Bin	Min.	Max.	Unit
A	1.7	2.0	V
B	2.0	2.3	

Luminous Intensity I_V @ I_F=10mA

Bin	Min.	Max.	Unit
3L	150	187	mcd
3M	187	234	
3N	234	300	
3K	300	375	
3P	375	469	

Dominant Wavelength λ_D @ I_F=10mA

Bin	Min.	Max.	Unit
s	615	620	nm
t	620	625	
u	625	630	

Characteristic Curves

Forward Current vs. Forward Voltage

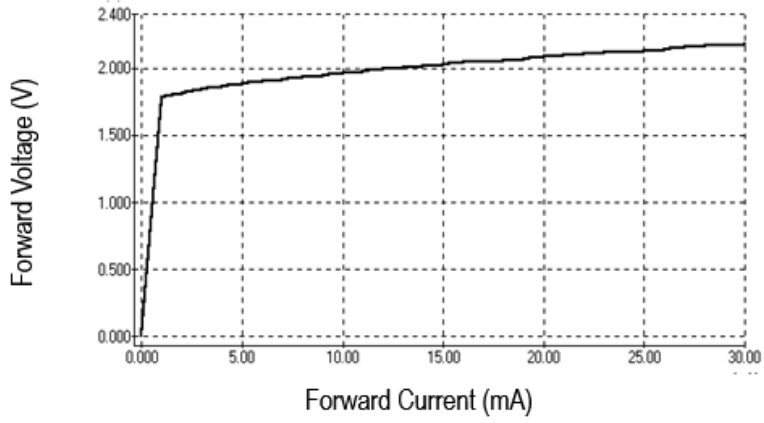

Relative Intensity vs. Wavelength

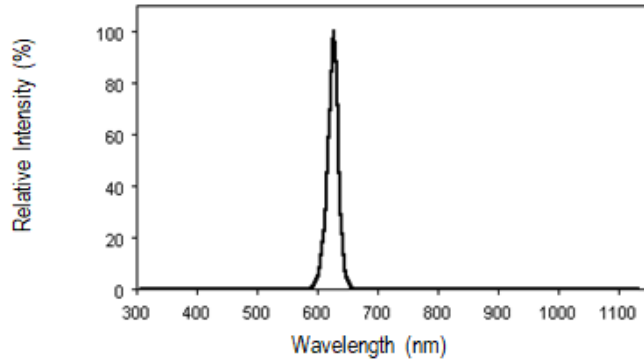

Directive Characteristics

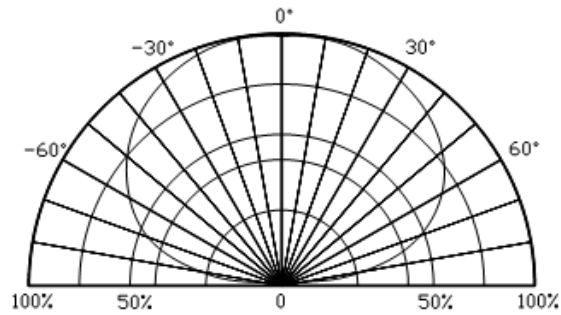

Solder Profile & Footprint

-The recommended reflow soldering profile is as follows (temperatures indicated are as measured on the surface of the LED resin):

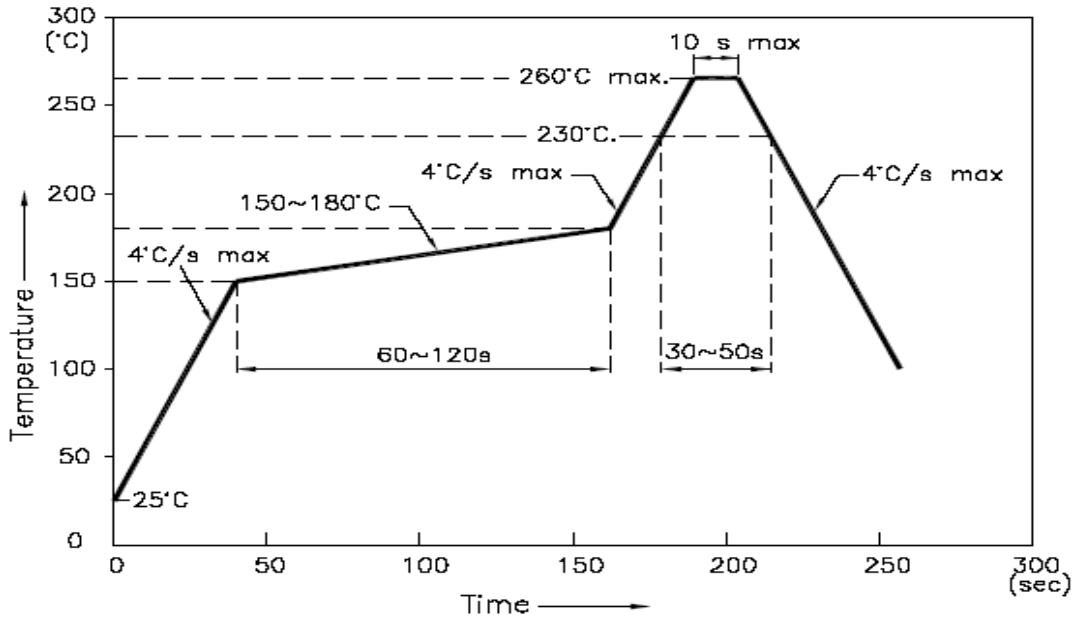

Recommended Pad Layout

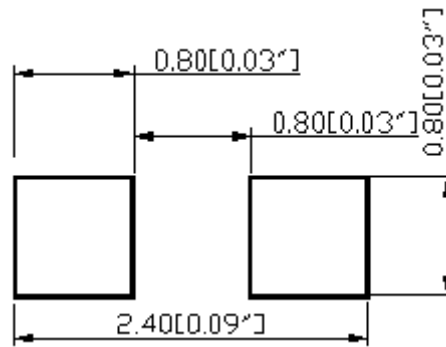

Units: mm

Packing

Reel Dimension:

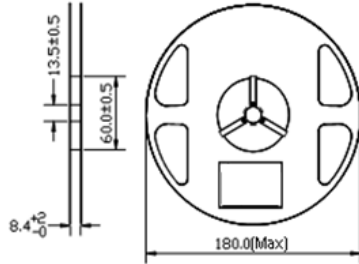

Unit: mm

Tape Dimension:

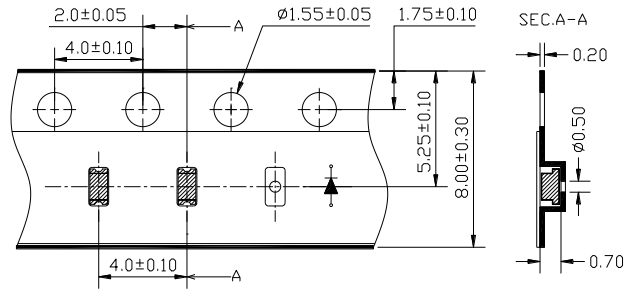

Unit: mm

Arrangement of Tape:

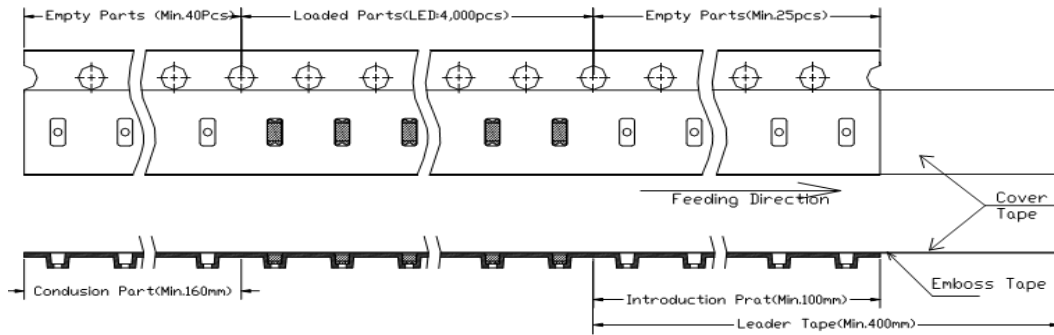

Packaging Specifications:

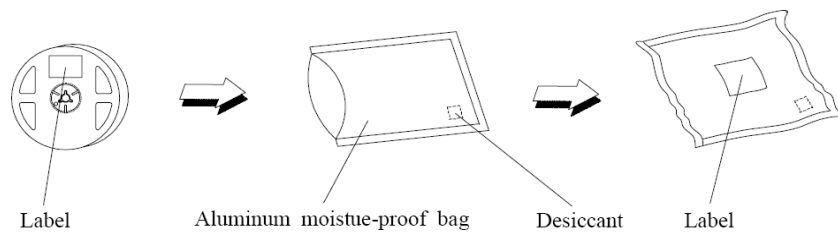

Labeling



Part No: _____
Customer P/N: _____
Item: _____
Q'ty: _____
Vf: _____
Iv: _____
WI: _____
Date: _____

Made in China

Ordering Information

Orderable Part #	Spec Range	Quantity per reel
QBLP601-RA-2897	Iv=250mcd typ. @ I _F =10mA / λ _D =615nm to 630nm	4,000 units



Revision History

Description:	Revision #	Revision Date
New Release of QBLP601-RA-2897	V1.0	10/29/2025

Disclaimer

QT-BRIGHTEK reserves the right to make changes without further notice to any products herein to improve reliability, function or design. QT-BRIGHTEK does not assume any liability arising out of the application or use of any product or circuit described herein; neither does it convey any license under its patent rights, nor the rights of others.

Life Support Policy

QT-BRIGHTEK's products are not authorized for use as critical components in life support devices or systems without the express written approval of QT-BRIGHTEK. As used herein:

1. Life support devices or systems are devices or systems which, (a) are intended for surgical implant into the body, or (b) support or sustain life, and (c) whose failure to perform when properly used in accordance with instructions for use provided in the labeling, can be reasonably expected to result in a significant injury of the user.
2. A critical component in any component of a life support device or system whose failure to perform can be reasonably expected to cause the failure of the life support device or system, or to affect its safety or effectiveness.

Product: QBLP601-RA-2897	Date: October 29, 2025	Page 9 of 9
	Version# 1.0	