

**QT-Brightek PLCC Series**

**Dome Type PLCC4 LED**

**Part No.: QBLP677AD-YD-2897**

**AD: Common Anode with Dome Lens  
D: 50mA Testing Current  
2897: High Bright**



**Table of Contents:**

Introduction ..... 3

Electrical / Optical Characteristic (Ta=25 °C) ..... 4

Absolute Maximum Rating ..... 4

Characteristic Curves..... 5

Solder Profile & Footprint..... 6

Handling Precautions..... 7

Packing ..... 8

Labeling ..... 9

Ordering Information ..... 9

Revision History ..... 10

Disclaimer ..... 10

## Introduction

### Feature:

- Water Clear lens
- Ultra bright PLCC4 LED
- Common anode
- Viewing Angle: 30° typ.
- MSL 3
- Height profile: 3.6mm

### Application:

- Warning light
- Emergency light
- Architecture lighting

### Certification & Compliance:

- ISO9001
- RoHS Compliant



### Dimension:

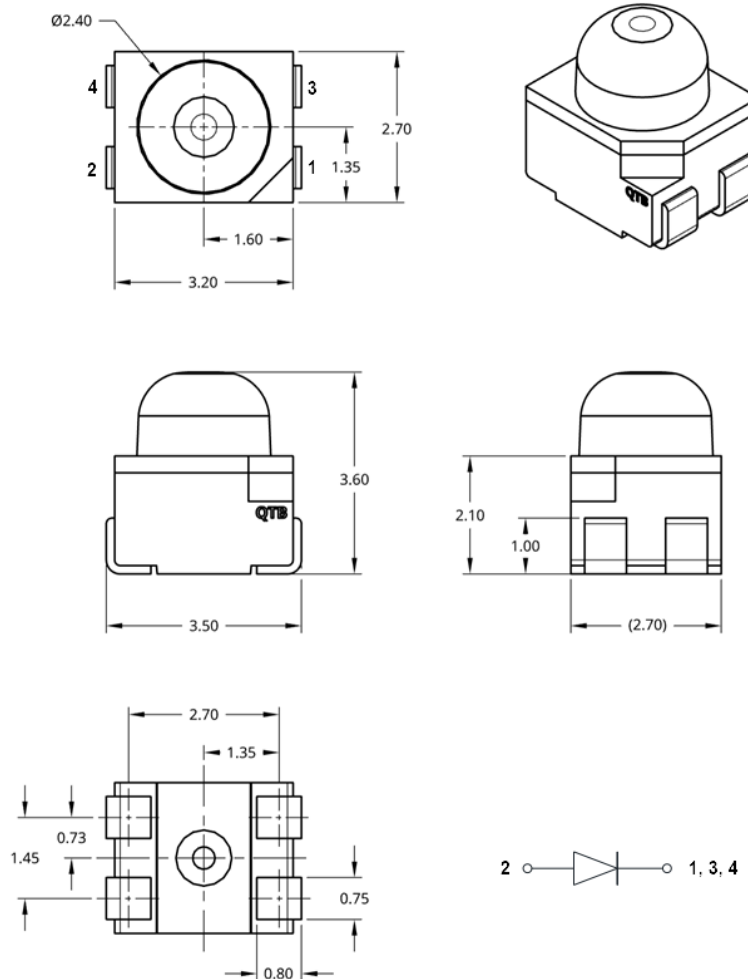

Units: mm / tolerance = +/-0.2mm

## Electrical / Optical Characteristic (Ta=25 °C)

Product	Color	I <sub>F</sub> (mA)	V <sub>F</sub> (V)		λ <sub>D</sub> (nm)			λ <sub>P</sub> (nm)	I <sub>V</sub> (mcd)		
			Typ.	Max.	Min.	Typ.	Max.	Typ.	Min.	Typ.	Max.
QBLP677AD-YD-2897	Yellow	50	2.2	2.8	586	590	595	592	8000	16600	26485

## Absolute Maximum Rating

Chip Material	P <sub>d</sub> (mW)	I <sub>F</sub> (mA)	I <sub>FP</sub> (mA)*	V <sub>R</sub> (V)	T <sub>OP</sub> (°C)	T <sub>ST</sub> (°C)	T <sub>SOL</sub> (°C)**
AllnGaP	196	70	150	5	-40 ~ +90	-40 ~ +90	240

\*Duty 1/10 @ 1KHz

\*\*IR Reflow for no more than 8 sec @ 240 °C

## Forward Voltage V<sub>F</sub> @ I<sub>F</sub>=50mA

Bin	Min.	Max.	Unit
1	1.9	2.2	V
2	2.2	2.5	
3	2.5	2.8	

## Luminous Intensity I<sub>V</sub> @ I<sub>F</sub>=50mA

Bin	Min.	Max.	Unit
2b	8000	10352	mcd
2c	10352	13178	
2d	13178	16710	
2e	16710	21188	
2f	21188	26485	

## Dominant Wavelength λ<sub>D</sub> for @ I<sub>F</sub>=50mA

Bin	Min.	Max.	Unit
A	586	589	nm
B	589	592	
C	592	595	

## Characteristic Curves

Relative Intensity vs. Wavelength

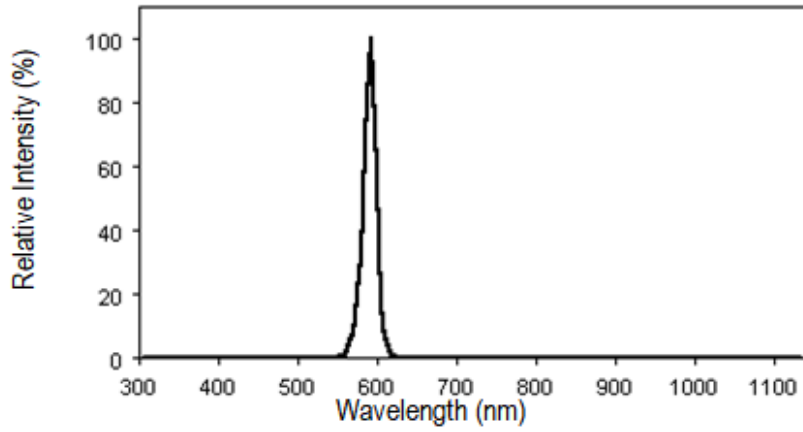

Forward Current vs. Forward Voltage

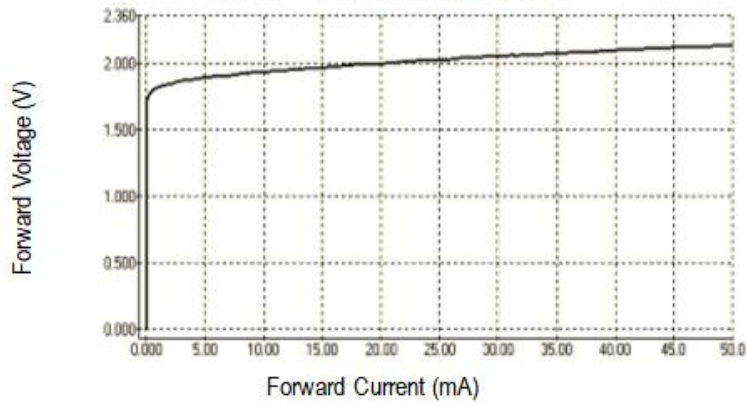

Directive Characteristics

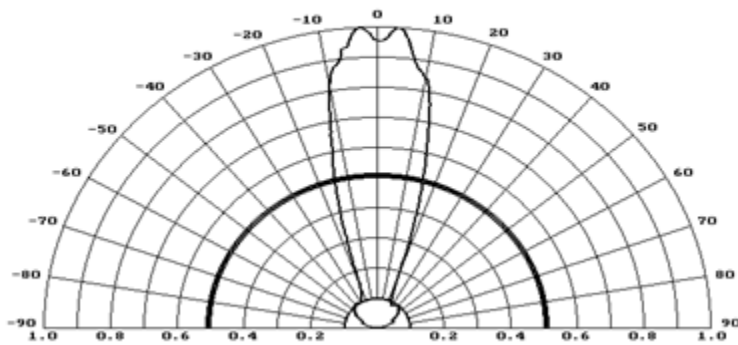

## Solder Profile & Footprint

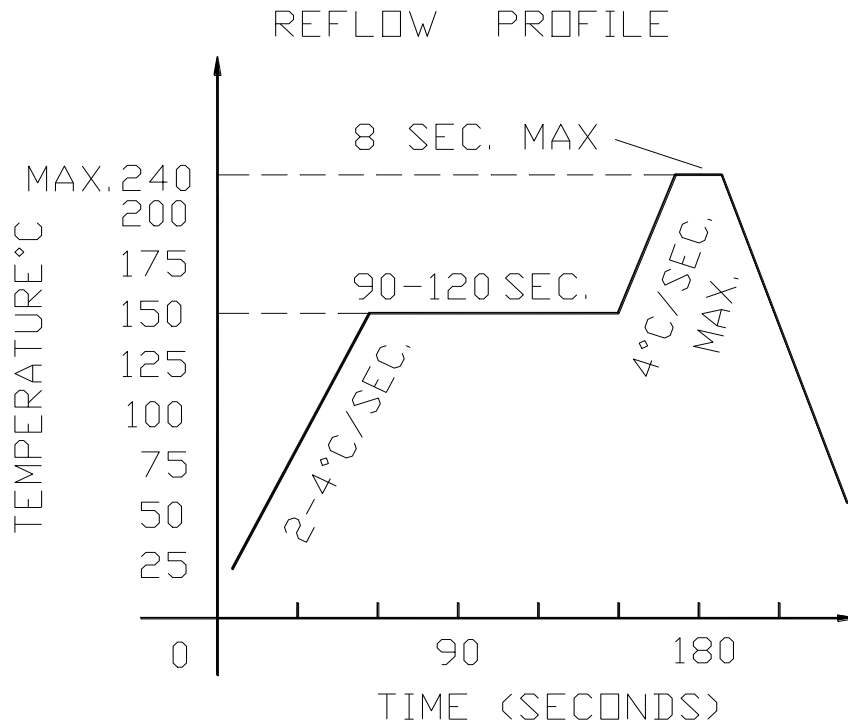

### Recommend Pad Layout

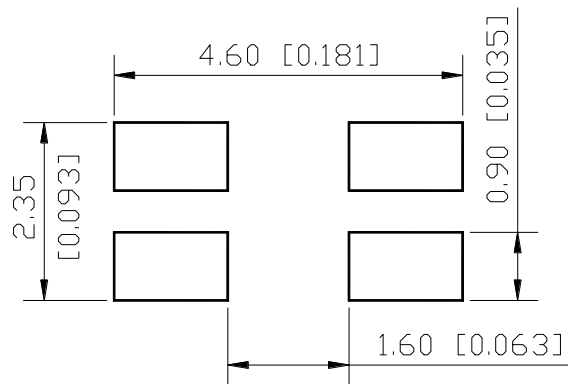

Units: mm

## Handling Precautions

1. It is recommended to store the products in sealed and anti-static bags with desiccant inside at the following condition:

- Humidity: <60% RH
- Temperature: 5°C~30°C

2. Shelf life in sealed bag: 12 month at 5°C~30°C and <60% R.H

3. After the package is opened:

3.1 The products should be used within a week (168 hours)

3.2 Or product should be stored at  $\leq 20\%$  RH and (5°C~30°C) with zip-lock sealed bag

3.3 It is recommended to bake before soldering when the package is unsealed after 72hrs;

3.3.1 Baking condition (Tape and Reel Type): 60±3°C (24~36 hrs) and < 5% RH

3.4 Products require baking before soldering/mounting if **3.1** or **3.2** is not met. Baking condition refers to **3.3.1**

4. If the product is not used within 3 months since manufacturing date, it is recommended to bake for 24 hrs @ 60°C before use.

5. If the product is not used after 3 months since manufacturing date, it is recommended to bake for 36~48 hrs @ 60°C before use.

Product: QBLP677AD-YD-2897	Date: December 17, 2025	Page 7 of 10
	Version# 1.0	

## Packing

### Reel Dimension:

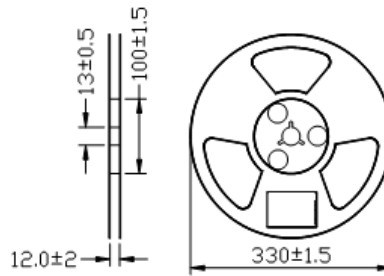

Unit: mm

### Dimensions of Tape:

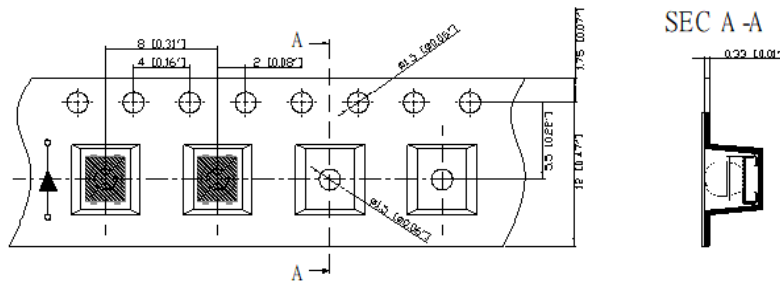

Unit: mm

### Arrangement of Tape:

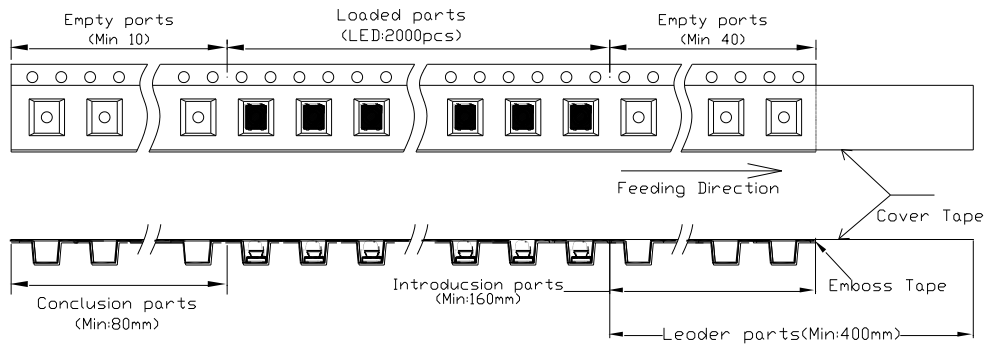

### Packaging Specifications:

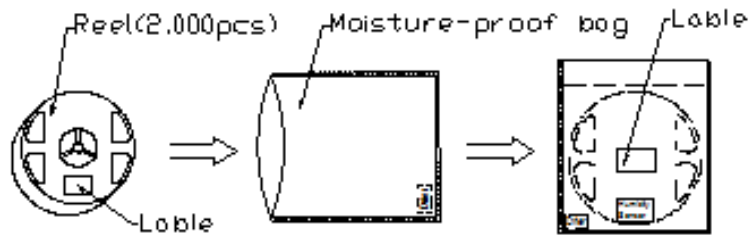

## Labeling



Part No: \_\_\_\_\_  
Customer P/N: \_\_\_\_\_  
Item: \_\_\_\_\_  
Q'ty: \_\_\_\_\_  
Vf: \_\_\_\_\_  
Iv: \_\_\_\_\_  
WI: \_\_\_\_\_  
Date: \_\_\_\_\_

**Made in China**

## Ordering Information

Orderable Part #	Spec Range	Quantity per Reel
QBLP677AD-YD-2897	Iv=16600mcd typ., $\lambda_D=586\text{nm to }595\text{nm @}$ I <sub>F</sub> =50mA	2000 units



## Revision History

Description:	Revision #	Revision Date
New Release of QBLP677AD-YD-2897	V1.0	12/17/2025

## Disclaimer

QT-BRIGHTTEK reserves the right to make changes without further notice to any products herein to improve reliability, function or design. QT-BRIGHTTEK does not assume any liability arising out of the application or use of any product or circuit described herein; neither does it convey any license under its patent rights, nor the rights of others.

## Life Support Policy

QT-BRIGHTTEK's products are not authorized for use as critical components in life support devices or systems without the express written approval of QT-BRIGHTTEK. As used herein:

1. Life support devices or systems are devices or systems which, (a) are intended for surgical implant into the body, or (b) support or sustain life, and (c) whose failure to perform when properly used in accordance with instructions for use provided in the labeling, can be reasonably expected to result in a significant injury of the user.
2. A critical component in any component of a life support device or system whose failure to perform can be reasonably expected to cause the failure of the life support device or system, or to affect its safety or effectiveness.

Product: QBLP677AD-YD-2897	Date: December 17, 2025	Page 10 of 10
	Version# 1.0	